

LS Skewable Angle

Designed to attach timber members at irregular angles, these connectors can be bent on site from 0° to 135°. The staggered nail pattern reduces the possibility for splitting the timber and allows installation on both sides of the member. LS can also be used to steel to steel.

Features

Material

- Pre-galvanised mild steel.

Benefits

- Site skewable.

Applications

Header member

- **Timber to timber.**
- **Steel to steel**

For Use With

- Timber and Steel construction.

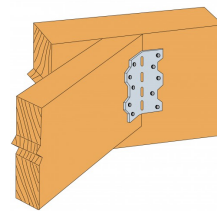
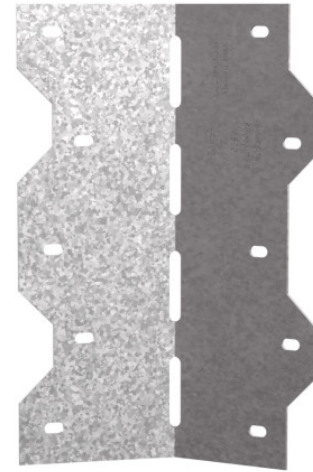

LS

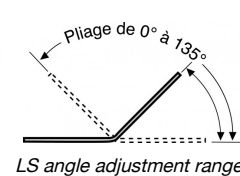

LS
Skewable Angle

Technical Data

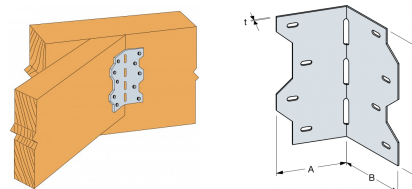

Product Dimensions

References	Product Dimensions [mm]				Joist	Holes Flange B	Weight [kg]
	A	B	C	t	Ø4x7 Obround	Ø4x7 Obround	
LS30	57	57	86	1.2	3	3	0.19
LS50	57	57	124	1.2	4	4	0.26
LS70	57	57	162	1.2	5	5	0.34

LS

Product capacities - Timber to timber - Full nailing - 1 bracket

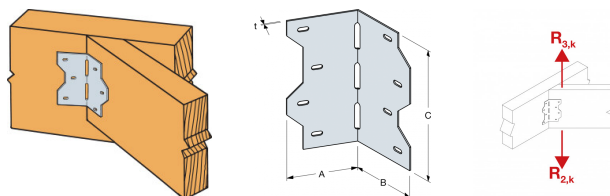

References	Product capacities - Timber to timber - Full nailing					
	Number of Fasteners		Characteristic capacities - Timber C24 - 1 angle brackets per connection [kN]			
	Joist	Flange B	$R_{2,k} = R_{3,k}$			
	Qty	Qty	Round smooth nail 3.75x75		CNA3.7x50	
LS30	3	3	1.7		2.8	
LS50	4	4	2.6		4.3	
LS70	5	5	2.6		4.4	

LS Skewable Angle

Installation

Fixing

- Timber: N3.75x75mm Round Wire Nails
- Steel: Ø 4.8 mm screws.

Installation

Adjust on site from 0 though to 135 degrees.

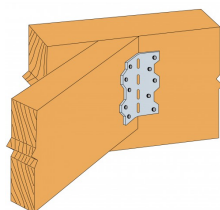

LS

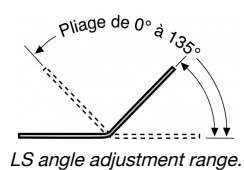

LS
Skewable Angle

